

SPECIALTY COATING PUMPS

PULSE FREE FLOW

PRECISE

CLEANABILITY



Specifically engineered to address the critical need for precise and pulse-free fluid delivery in the Slot Die Coating industry, the Northern Coating metering pump was developed to meet these demanding requirements. Its specialized gear design, combined with its inherent ability to adapt easily to flow variations, ensures that coating systems can consistently apply uniform coating thicknesses across a diverse range of materials commonly encountered in slot die processes. Recognizing the importance of operational efficiency, this pump features a design that allows for rapid disassembly and cleaning within minutes, utilizing only simple hand tools.

The Northern NPC pulse-free pumps and the 4000 series pumps are currently essential components in a variety of coating applications. Beyond their foundational role in the Slot Die Coating industry, they are also extensively utilized in the production of lithium ion batteries, medical devices, pharmaceuticals, adhesives, and numerous other industrial coating processes where accuracy and reliability are paramount.

4000 Series Specifications:

- Frame Sizes Available: 4300, 4400, 4500, 4600
- Flow Rates up to 80 GPM
- Viscosity Range: 0.5 to 1,500,000cP
- Temperature Range: -65°F to 850°F
- Inlet Capacity: 28" HG to 1200 PSIG
- NPT, Flanged, and Custom Connections
- Available in Carbon Steel or Stainless Steel

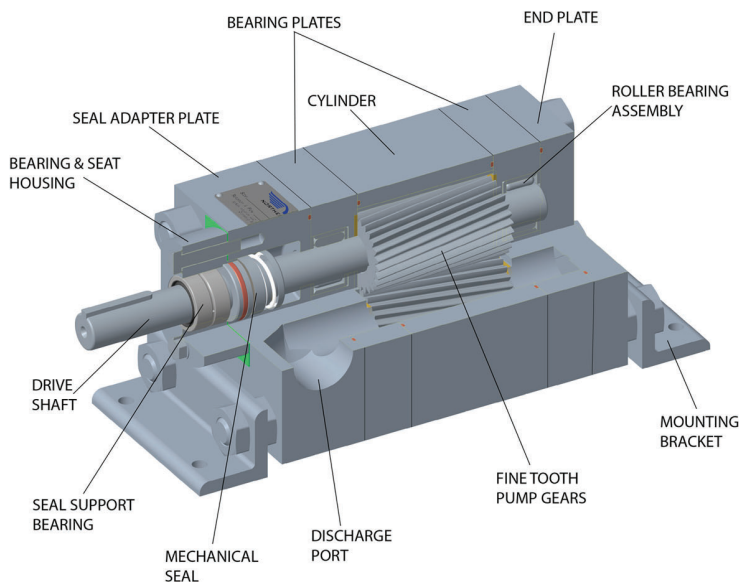

Pump Series	Max Flow (GPM)	Max Speed (RPM)	Max ΔP (PSI)
4300	5	3550	Up to 2000 PSI
4400	17	3550	
4500	27	3550	
4600	83	3550	

*Flow, RPM, and Differential Pressure are highly dependent on each specific application

Innovative
Engineering

Superior Quality

Flexible Design

Phone: 800-366-1410

www.northern-pump.com

E-mail:
info@northern-pumps.com

Office:
340 W Benson Aveune
Grantsburg WI 54840



Made in the USA

Contact us with your application today!

NPC Pump Offers

- Pulse Free Flow
- Meter Precision
- Fast and Complete Breakdown for Cleaning and Reassembly
- Total Rebuildability
- Extensive Chemical Compatibility

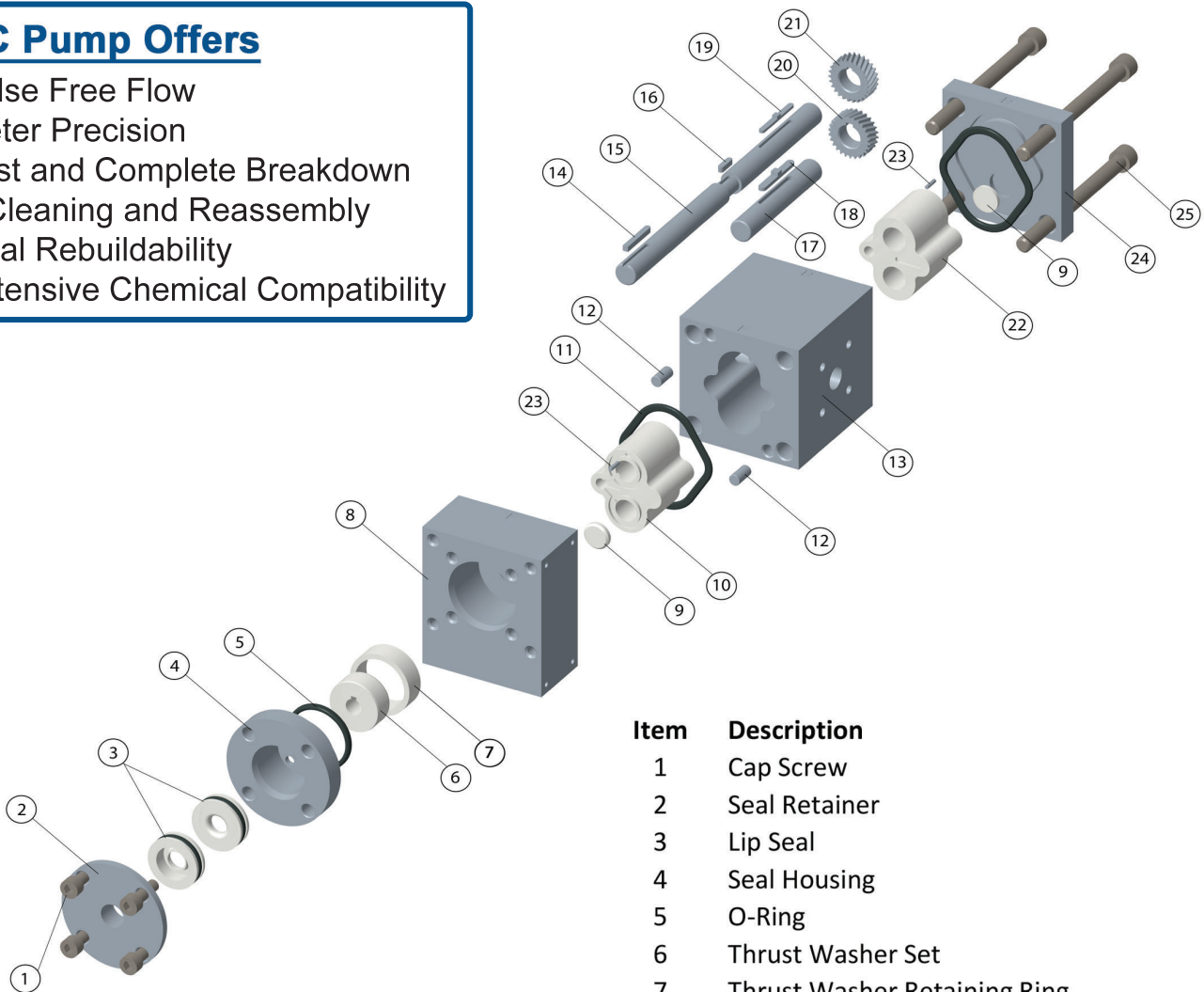

Specifications

- Flow: 0.5, 1, 3, 5, 10, 15 cc/rev
- Max Pressure: 100 PSI
- Max Temperature: 150F
- Max Speed: 250 RPM
- Inlet / Outlet: 3/8" & 5/8"
- Flows (LPM & Max RPM): 0.13, 0.25, 0.75, 1.25, 2.5, 3.75

Materials of Construction

- Pump Body: 316 Stainless Steel
- Gears: 17-4 Stainless Steel
- Bearing Inserts: Glass Filled PTFE / PEEK

Options

- Seal: Lip Seal & Packing
- Kolterized Coated Internals
- Inlet / Outlet Options: NPT, Sanitary Flanges, Custom apadters availalbe.

Item	Description	Qty.
1	Cap Screw	4
2	Seal Retainer	1
3	Lip Seal	2
4	Seal Housing	1
5	O-Ring	1
6	Thrust Washer Set	2
7	Thrust Washer Retaining Ring	1
8	Seal Adapter Plate	1
9	Thrust Disk	2
10	Front Bearing Insert	1
11	O-Ring	2
12	Dowel Pin	2
13	Cylinder	1
14	Drive Shaft End Key	1
15	Drive Shaft	1
16	Thrust Washer Key	1
17	Driven Shaft	1
18	Driven Shaft Gear Key	1
19	Drive Shaft Gear Key	1
20	Driven Gear, RH Gear	1
21	Drive Gear, LH Gear	1
22	Rear Bearing Insert	1
23	Bearing Insert Dowel Pin	2
24	End Plate	1
25	Cap Screw	4

Two Body Sizes with three capacities each allows total system flexibility



NORTHERN PUMP

Manufacturing the Highest Quality Pumps for over 85 years

Phone: 800 - 366 - 1410

www.northern-pump.com

E-mail: info@northern-pump.com

340 W Benson Avenue, Grantsburg WI 54840

Fax: 715-463-5174