

PUMP GEAR OPTIONS HELICAL & SPUR



8620 ALLOY STEEL

- *Most versatile option*
- *Excellent for most applications*
- *Carburize Hardened & Ground Profile*



NITRIDING STEEL

- *Great for high temperatures*
- *Highest surface hardness*
- *Nitride Hardened & Ground Profile*

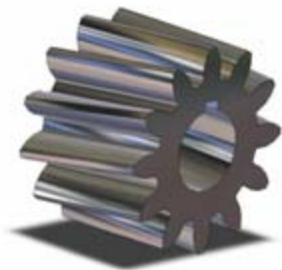

440-C STAINLESS STEEL

- *Corrosion resistant option*
- *Through hardened construction*
- *Ground Profile*



HERRING BONE DESIGN

- *High Thrust Applications*
- *All Materials*
- *Precision machined & matched keyways*

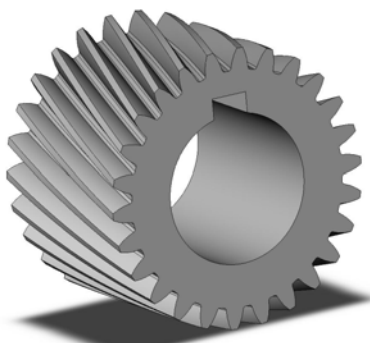

SPECIAL HELIX ANGLES

- *Coatings and other precise applications*
- *Virtually pulse free*
- *All materials*